

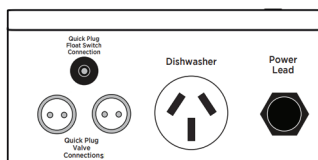

# Sanialarm® Interlock

The Sanialarm® Interlock has 3 functions, whereby it sets off an audible alarm in the event of a high level issue and simultaneously shuts off incoming water supply to prevent flooding whilst cutting the power supply to the dishwasher or washing machine. Additional option of a leak probe sensor variation is also available.



## WHY CHOOSE THIS PRODUCT?

- Helps protect against flooding
- Audible and visual alarm
- Power interlock for dishwasher or washing machine
- Easy and quick plug and play installation, no electrician required
- Suitable for new and existing Saniflo installations

Kit comes complete with magnetic float switch and one low voltage solenoid with pre wired plugs (additional solenoid purchased separately)

## TECHNICAL CHARACTERISTICS

<b>Voltage</b>	220-240 V/50 Hz
<b>Power consumption</b>	5 Watts
<b>Alarm</b>	80dB
<b>BMS (Building Management System) connective</b>	
<b>Dimensions</b>	200x200x90mm

**NOTE:** Warranty only applies when the Sanialarm Interlock is used with Saniflo SFA products.

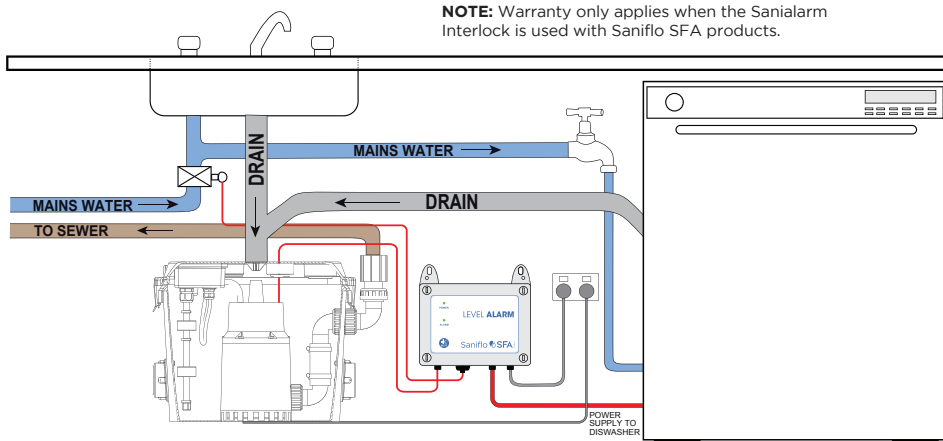

Shaking up water

This product is Made in Australia to the highest standards, needs to be installed by a licensed plumber